

Compact Cylinder (Large Bore Size)

C-CQ2 Series



Standard Specification

| Bore Size (mm) | 125 | 140 | 160 | 180 | 200 |
|-----------------------------|---|-----|------------|-----------|-----|
| Fluid | Air | | | | |
| Action | Double-acting | | | | |
| Proof Pressure | 1.5MPa(15.3kgf/cm ²) | | | | |
| Max. Operating Pressure | 1.0MPa(10.2kgf/cm ²) | | | | |
| Min. Operating Pressure | 0.05MPa (0.51kgf/cm ²) | | | | |
| Ambient & Fluid Temperature | -10~+60°C | | | | |
| Rod End Thread | Female thread(Standard) , Male thread(OPTION) | | | | |
| Cushion | Standard rubber bumper | | | | |
| Piston Speef | 50-500mm/s | | 20-400mm/s | | |
| Stroke Length Tolerance | +1.4 0 | | | | |
| *Lubrication | Not required | | | | |
| Mounting | Through-hoe and both end tapped | | | | |
| Tube Diameter | Rc(PT)3/8 | | | Rc(PT)1/2 | |

* Please use ISOVG32 if you want to use lubrication.

How To Order

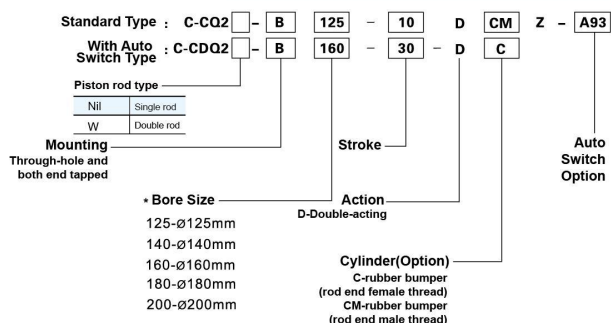

Ordering Sample

- ① Bore size: 125, stroke:20, rod end female thread , the right model no: C-CQ2B125-20DC
- ② Bore size:140, stroke:100, built-in auto switch,rod end male thread, the right model no: C-CDQ2B140-100DCM

Stroke/Model Of Auto Switch

| Bore Size | Standard Stroke (mm) | Model Of Auto Switch | |
|-----------|----------------------|----------------------|---------|
| | | Perpendicular | In-line |
| 125 | 10,20,30,40,50, | M9NV | M9N |
| | | M9PV | M9P |
| | | M9BV | M9B |
| | | M9WV | M9W |
| 140 | 75,100,125, | M9WV | M9PW |
| | | M9BV | M9BW |
| | | M9NAV** | M9NA** |
| | | M9PAV** | M9PA** |
| 160 | 150,175,200, | M9BAV** | M9BA** |
| | | - | P3DW |
| | | A96V | A96 |
| | | A93V | A93 |
| 180 | 250,300 | A90V | A90 |

Dimension(mm)

C-CQ2B/C-CDQ2B
 Ø125-Ø160

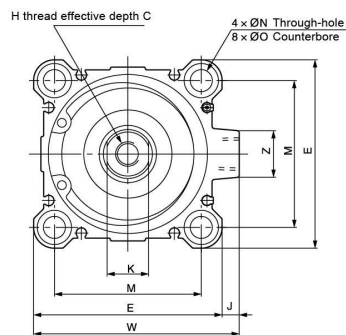
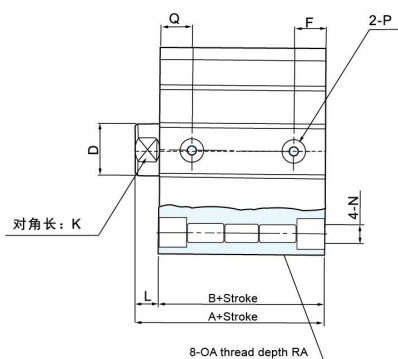

(): The auto switch magnet size besides D-A7

| Bore Size | Standard Stroke (mm) | A | B | C | D | E | F | H | I | J | K | L | M | N | OA | OB | P | Q | RA | RB | Z |
|-----------|----------------------|-----|----|----|-----|-----|------|---------|-----|----|----|----|-----|------|-------|------|-------|------|----|------|----|
| 125 | 10,20,30,40,50 | 99 | 83 | 30 | Ø36 | 142 | 24.5 | M22×2.5 | 190 | 11 | 32 | 16 | 114 | 12.5 | M14×2 | 21.2 | Rc3/8 | 24.5 | 25 | 18.4 | 32 |
| | 75,100,125,150 | 99 | 83 | 30 | Ø36 | 158 | 24.5 | M22×2.5 | 210 | 10 | 32 | 16 | 128 | 12.5 | M14×2 | 21.2 | Rc3/8 | 24.5 | 25 | 18.4 | 32 |
| 160 | 175,200,250,300 | 108 | 91 | 33 | Ø40 | 178 | 27.5 | M24×3 | 238 | 10 | 36 | 17 | 144 | 14.5 | M16×2 | 24.2 | Rc3/8 | 27.5 | 28 | 21.2 | 32 |

Compact Cylinder (Large Bore Size)

C-CQ2 Series

Dimension(mm)

Rod end male thread

| Bore Size (mm) | A | C | D | H | K | L | X |
|----------------|-----|----|-----|---------|----|----|----|
| 125 | 141 | 42 | Ø36 | M30×1.5 | 32 | 58 | 45 |
| 140 | 141 | 42 | Ø36 | M30×1.5 | 32 | 58 | 45 |
| 160 | 155 | 47 | Ø40 | M36×1.5 | 36 | 64 | 50 |

C-CQ2B/C-CDQ2B (Rod end male thread)

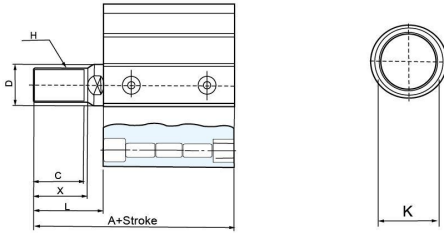

Double-piston Rod Type C-C□Q2WB (Rod end female thread) Bore Size - Stroke DC

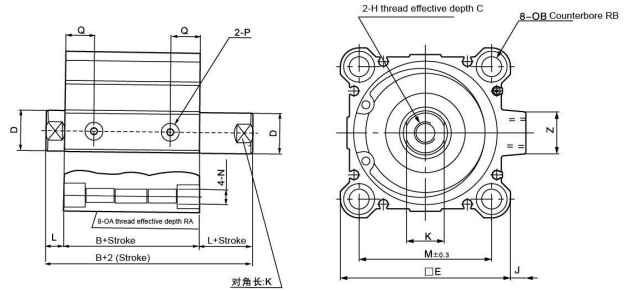

() : The auto switch magnet size besides D-A7

| Bore Size | Standard Stroke | A | B | C | D | E | H | I | J | K | L | M | N | OA | OB | P | Q | RA | RB | Z |
|-----------|-----------------|-----|----|----------|-----|-----|---------|-----|----|----|----|-----|------|-------|------|-----|------|----|------|----|
| 125 | 10,20,30,40,50, | 115 | 83 | 30(22.5) | Ø36 | 142 | M22×2.5 | 190 | 11 | 32 | 16 | 114 | 12.5 | M14×2 | 21.2 | 3/8 | 24.5 | 25 | 18.4 | 32 |
| 140 | 75,100,125,150, | 115 | 83 | 30(22.5) | Ø36 | 158 | M22×2.5 | 210 | 10 | 32 | 16 | 128 | 12.5 | M14×2 | 21.2 | 3/8 | 24.5 | 25 | 18.4 | 32 |
| 160 | 175,200,250,300 | 125 | 91 | 33(26.5) | Ø40 | 178 | M24×3 | 238 | 10 | 36 | 17 | 144 | 14.5 | M16×2 | 24.2 | 3/8 | 27.5 | 28 | 21.2 | 32 |

Rod end male thread

| Bore Size | A | C | D | H | K | L | X |
|-----------|-----|----|-----|---------|----|----|----|
| 125 | 199 | 42 | Ø36 | M30×1.5 | 32 | 58 | 45 |
| 140 | 199 | 42 | Ø36 | M30×1.5 | 32 | 58 | 45 |
| 160 | 219 | 47 | Ø40 | M36×1.5 | 36 | 64 | 50 |

Double-piston rod type C-C□Q2WB (Rod end male thread) Bore Size - Stroke DCM

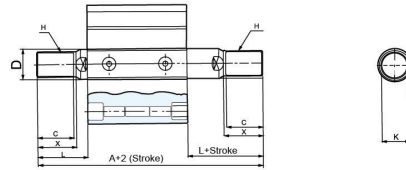

C-CQ2B/C-CDQ2B(Ø180)

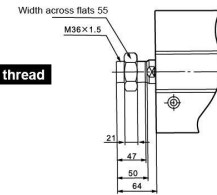
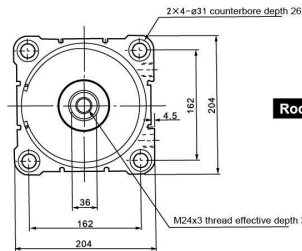
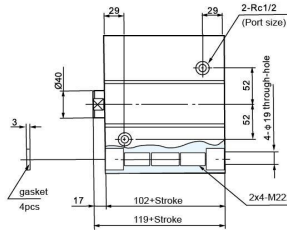

C-CQ2B/C-CDQ2B(Ø200)

