

Compact Cylinder (Long Stroke)

C-CQ2 Series



Standard Specification

Bore Size (mm)	32	40	50	63	80	100
Fluid	Air					
Action	Double-acting					
Operating Pressure Range	0.05-1.0MPa					
Ambient & Fluid Temperature	With auto switch: -10°C~+60°C, Without auto switch: -10°C~+70°C					
Rod End Thread	Female thread(Standard) Male thread(Optional)					
Piston Speed	50~500mm/s					
Cushion	Standard rubber bumper					
Stroke Length Tolerance (mm)	+1.4 0					
Lubrication	Not required					
Mounting	Both end tapped(Standard)					
Tube diameter Rc	1/8	1/4	3/8			

* Please use ISOVG32 if you want to use lubrication

How To Order

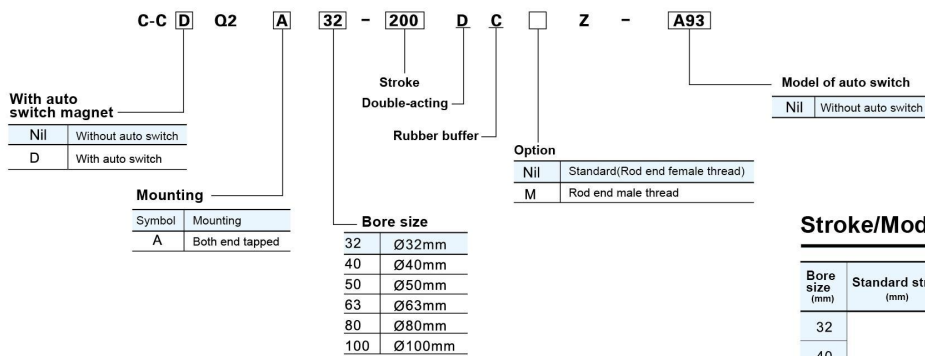

Stroke/Model Of Auto Switch

Bore size (mm)	Standard stroke (mm)	* Model of auto switch	
		Perpendicular	In-line
32	125, 150, 175, 200, 250, 300	M9NV	M9N
		M9PV	M9P
		M9BV	M9B
		M9WV	M9W
40	125, 150, 175, 200, 250, 300	M9PW	M9PW
		M9WV	M9W
		M9AV**	M9A**
		M9PAV**	M9PA**
50	125, 150, 175, 200, 250, 300	M9AV**	M9A**
		M9PAV**	M9PA**
		M9AV**	M9A**
		M9PAV**	M9PA**
63	125, 150, 175, 200, 250, 300	M9AV**	M9A**
		M9PAV**	M9PA**
		M9AV**	M9A**
		M9PAV**	M9PA**
80	125, 150, 175, 200, 250, 300	A96V	A96
		A93V	A93
		A90V	A90
		A96V	A96
100	125, 150, 175, 200, 250, 300	A93V	A93
		A90V	A90
		A96V	A96
		A93V	A93

Ordering Sample

- ① Bore size: 32, stroke:125, double-acting with auto switch both end female thread, rod end male thread, rubber buffer, the model is: C-CDQ2A32-125DCM

Dimension(mm)

Rod end female thread

C-CQ2A/C-CDQ2

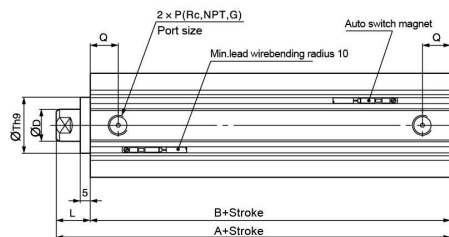

Rod end male thread

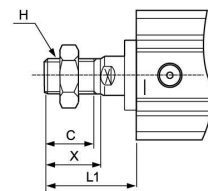
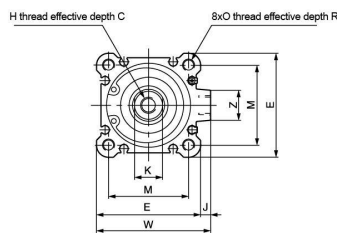

(): The auto switch magnet size besides D-A7

Bore size (mm)	Stroke	A	B	C	D	E	G	H	I	J	K	L	M	O	P	Q	R	S	T _{Hg}	U	Z	Bore size (mm)	C	H	L1	X	
32	125-200	62.5	45.5	13	16	45	5	M8×1.25	60	4.5	14	17	34	M6×1.0	RC1/8	12.5	10	58.5	22 ⁰ _{-0.052}	31.5	14	32	20.5	M14×1.5	38.5	23.5	
		40	72	55	13	16	52	5	M8×1.25	69	5	14	17	40	M6×1.0	RC1/8	14	10	66	28 ⁰ _{-0.052}	35	14	40	20.5	M14×1.5	38.5	23.5
		50	73.5	55.5	15	20	64	5	M10×1.5	86	7	17	18	50	M8×1.5	RC1/4	14	14	80	35 ⁰ _{-0.062}	41	19	50	26	M18×1.5	43.5	28.5
		63	75	57	15	20	77	5	M10×1.5	103	7	17	18	60	M10×1.5	RC1/4	16.5	18	93	35 ⁰ _{-0.062}	47.5	19	63	26	M18×1.5	43.5	28.5
		80	86	66	21	25	98	5	M16×2.0	132	6	22	20	77	M12×1.75	RC3/8	19	22	112.5	43 ⁰ _{-0.062}	57.5	26	80	32.5	M22×1.5	53.5	35.5
100	97.5	75.5	27	30	117	5	M20×2.5	156	6.5	27	22	94	M12×1.75	RC3/8	23	22	132.5	59 ⁰ _{-0.074}	67.5	26	100	32.5	M26×1.5	53.5	35.5		