

# Vacuum Filter CBF SERIES

## How To Order

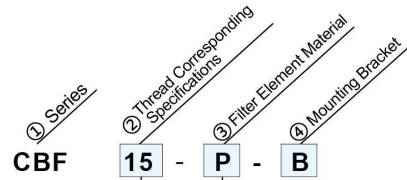

② Thread Corresponding Specifications	
10	G3/8 Internal thread
15	G1/2 Internal thread
20	G3/4 Internal thread
25	G1 Internal thread
40	G1 1/2 Internal thread

③ Filter Element Material	
P	PE, filtration accuracy 10 $\mu$ m

## Product Features

1. Filter out dust and impurities from air supply port.
2. Transparent shell to check the pollution degree of filter directly.
3. Easy to change the filter element.
4. Decrease the danger that may cause by stopping of vacuum pump or vacuum generator.
5. Different nominal flow specification to choose.

## Range Of Application

1. Apply to vacuum system with moderate to light pollution.
2. Used for pre-filter, also can filter out different degrees of dust.

## Performance Parameter

Model	Applicable Pressure Range (kPa)	Material	Temperature Range (°C)	Filtration Accuracy ( $\mu$ m)	Nominal Flow (L/min)	Internal Vacuum (cm <sup>3</sup> )	Filter Area (m <sup>2</sup> )	Weight (g) PE
CBF10	-100~0	PE	-20~80	10	150	45	0.003	70
CBF15	-100~0	PE	-20~80	10	900	195	0.010	168
CBF20	-100~0	PE	-20~80	10	900	205	0.010	170
CBF25	-100~0	PE	-20~80	10	2520	495	0.019	424
CBF40	-100~0	PE	-20~80	10	5100	675	0.023	550

## Dimension (mm)

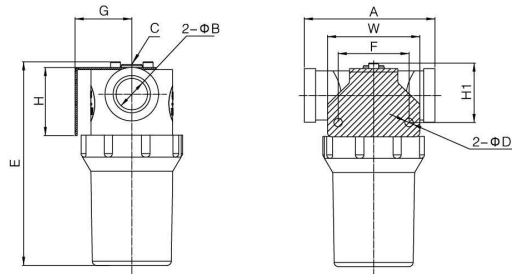

Model/Size	A	B	C	D	E	F	G	H	H1	W
CBF10	76.5	2-G3/8	NPFS1/8	6	74.5	50	40	48	43.5	65
CBF15	91.5	2-G1/2	NPFS1/8	6	134.5	50	40	48	43.5	65
CBF20	92	2-G3/4	NPFS1/8	6	143.5	50	40	48	43.5	65
CBF25	127	2-G1	NPFS1/8	6	169.5	70	56	52	48	85
CBF40	127	2-G1 1/2	NPFS1/8	6	212.5	70	56	52	48	85

## Maintenance Component Selection Specifications

### Mounting Bracket



Model	Suitable Filter
<b>CBF10 - B</b>	CBF 10 , CBF 15 , CBF 20
<b>CBF25 - B</b>	CBF 25 , CBF 40

### 滤芯



Model PE	Suitable Filter
<b>CBF10 - PE</b>	CBF 10
<b>CBF20 - PE</b>	CBF 15 , CBF 20
<b>CBF25 - PE</b>	CBF 25
<b>CBF40 - PE</b>	CBF 40