

型号表示方法

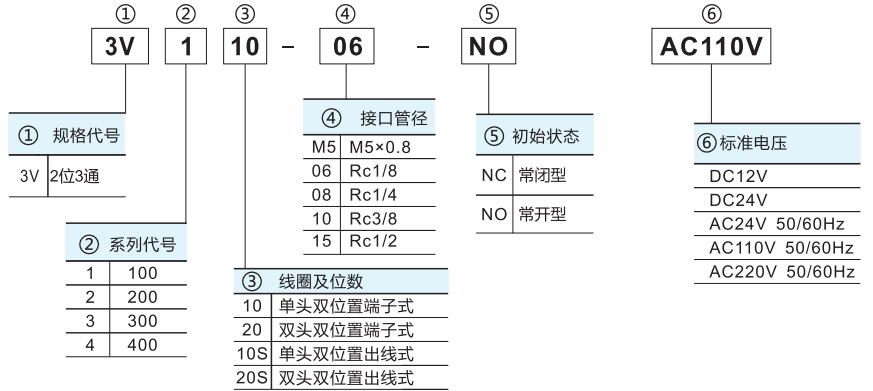

规格

允许的流体	空气
使用压力范围	0.15~0.8MPa
耐压	1.2MPa
工作温度范围	5~60°C
电压范围	-10%~+10%
保护等级	IP65
耐热等级	B级
接电型式	端子式
润滑	不需要
最高动作频率	5Hz

流量特性

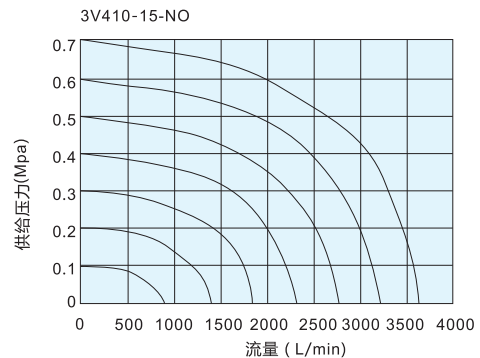
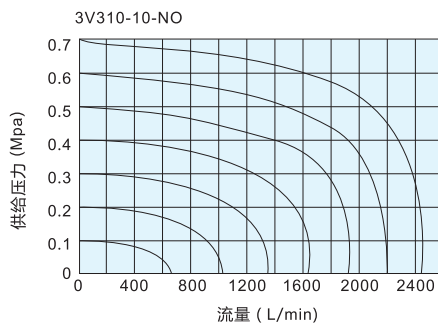
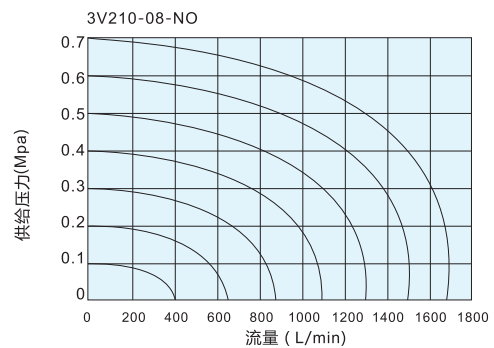
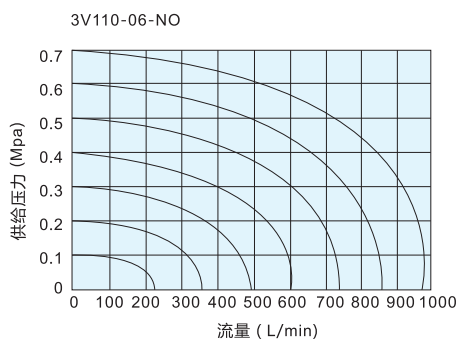

3V系列 先导式3通电磁阀

尺寸

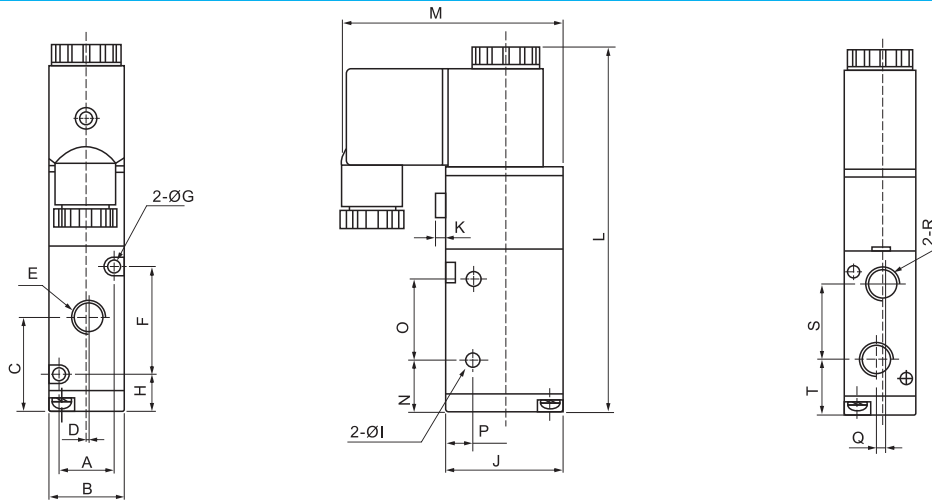

型号	A	B	C	D	E	F	G	H	I	J	K	L	M	N	O	P	Q	R	S	T
3V110-M5	13	18	22.7	0	M5x0.8	19	Ø3.3	13.2	Ø3.1	27	2.5	88.4	55	12.2	21	7.7	0	M5x0.8	14.2	14.7
3V110-06	13	18	23.7	1	Rc1/8	19	Ø3.3	13.2	Ø3.1	27	2.5	88.4	55	12.2	21	7.7	2	Rc1/8	16	14.7
3V210-06	17	22	27.7	0	Rc1/8	30	Ø3.2	12.7	Ø4.2	35	3	109	66.7	15.2	25	8.2	0	Rc1/8	22	16.7
3V210-08	17	22	28.7	1.5	Rc1/4	30	Ø3.2	12.7	Ø4.2	35	3	109	66.7	15.2	25	8.2	0	Rc1/4	22.5	16.7
3V310-08	20	27	32.5	0	Rc1/4	35	Ø4.3	15	Ø4.3	40	2.4	120	69.2	17.5	30	10.5	0	Rc1/4	24	20.5
3V310-10	20	27	32.5	2	Rc3/8	35	Ø4.3	15	Ø4.3	40	2.4	120	69.2	17.5	30	10.5	0	Rc3/8	24	20.5
3V410-15	27	34	42	3	Rc1/2	48	Ø4.5	17.5	Ø4.5	50	2.8	138	74	17.5	48	13	0	Rc1/2	35	25

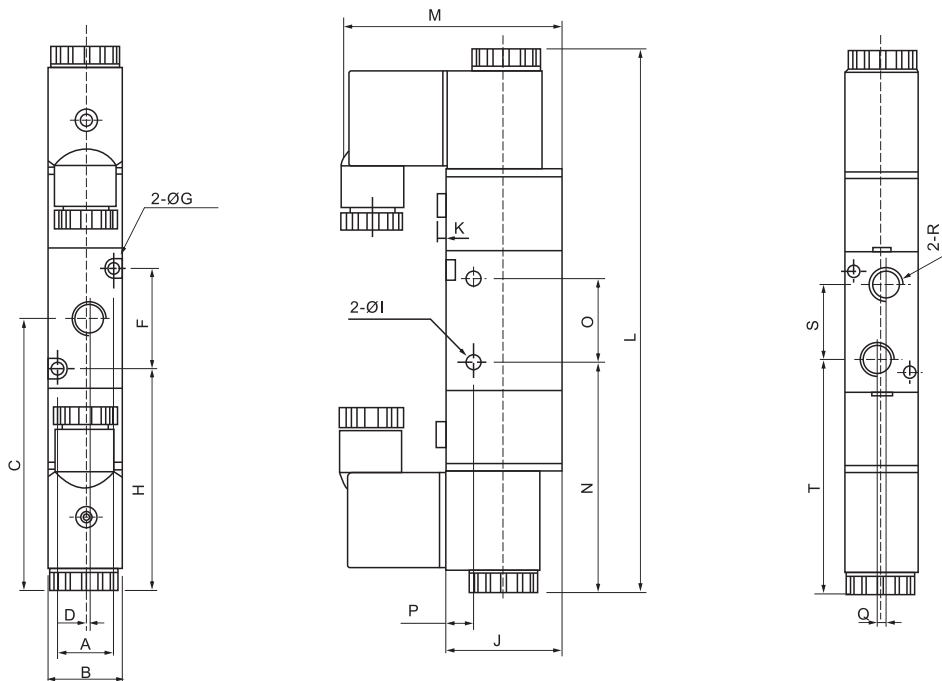

型号	A	B	C	D	E	F	G	H	I	J	K	L	M	N	O	P	Q	R	S	T
C-3V120-M5	13	18	65.7	0	M5x0.8	19	Ø3.3	56.2	Ø3.1	27	2.5	131.4	55	55.2	21	7.7	0	M5x0.8	14.2	57.7
C-3V120-06	13	18	66.7	1	Rc1/8	19	Ø3.3	56.2	Ø3.1	27	2.5	131.4	55	55.2	21	7.7	2	Rc1/8	16	57.7
C-3V220-06	17	22	81.4	0	Rc1/8	30	Ø3.2	66.4	Ø4.2	35	3	162.8	66.7	69	25	8.2	0	Rc1/8	22	70.2
C-3V220-08	17	22	82.4	1.5	Rc1/4	30	Ø3.2	66.4	Ø4.2	35	3	162.8	66.7	69	25	8.2	0	Rc1/4	22.5	70.2
C-3V320-08	20	27	87.4	0	Rc1/4	35	Ø4.3	70	Ø4.3	40	2.4	174.8	69.2	72.4	30	10.5	0	Rc1/4	24	75.4
C-3V320-10	20	27	87.4	2	Rc3/8	35	Ø4.3	70	Ø4.3	40	2.4	174.8	69.2	72.4	30	10.5	0	Rc3/8	24	75.4
C-3V420-15	27	34	96.5	3	Rc1/2	48	Ø4.5	72.5	Ø4.5	50	2.8	193	74	72.5	48	13	0	Rc1/2	35	79